

BUSINESS PROFILE



- Biosecurity Surveillance & Support
- Digital Therapeutics
- Healthcare Informatics
- Software as a Service
- Biosecurity Infrastructure

SYSBIOME

BUSINESS PHILOSOPHY

“Uncompromised Quality, Uncompromised Services”
&

“Driving Growth Through Customer Centric Innovations”

01 The Ethos

Our management philosophy values people as our greatest assets, prioritizing effective communication and strong interpersonal relations.

Our caring and future-oriented management team ensures well-organized and flexible planning and programming.

Our commitment to our ethos guarantees our consistent dedication to delivering our best in every project.

- CEO-

02 Mission Statement

Team Sysbiome is a highly motivated and focused team that delivers high-quality work while adhering to global guidelines, policies, and practices. We prioritize fair and true dealings with employees, clients, vendors, and partners, fostering strong relationships.

Our dependability, drive, and integrity make us a trusted choice for organizations and esteemed clients. We take pride in our accomplishments and strive to build upon them daily.



What We Do

- Thorough process analysis to identify gaps
- Efficiently filling gaps through research
- Incorporating latest and secure technologies
- Unmatched quality in services for clients



How We Do It

- Deep understanding of subject matter
- Comprehend needs and language of scientific audience
- Deliver user-friendly systems
- Seamlessly adapt to clients' working conditions

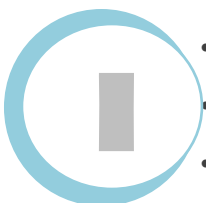

Innovation Principle

- Prioritize innovation as a disciplined approach
- Comprehensive customer-centric approach to innovation
- INNODROME- The Innovation Centre as a collaborative platform



i - C L D M A S

Integrated Clinical Lab Data
Management & Analysis System



- Integrated Bio-Surveillance solution:
 - Connects laboratories across different locations
 - Enhances monitoring capabilities
- Automated and secure lab operations:
 - Lab-specific end-to-end workflow and operations management
 - Sample management and security with QR/Barcode/Rfid/NFC infrastructure
 - State-of-the-art Bio-Security protocols
- Real-time access to laboratory status and data:
 - Stakeholders have immediate visibility into lab information
 - Enables quick decision-making for epidemiology management
- Precise analytics and reporting:
 - Multi-parameter tool provides accurate analytics
 - Generates detailed reports
- Automated patient report management:
 - Handles individual and bulk patient reports from hospitals and fields
 - Efficiently manages patient information



CLDMAS

Clinical Lab Data Management
& Analysis System

CLDMAS is software system equipped to map the Laboratory processes & protocols, tests, SOP's, Sample life cycle, Lab resources, sample banking, reports & analytics specifically to follow the standard operating protocols for pathogen based testing, tracking, reporting and monitoring in real time environment.

Software Features

- Sample Source Management
- Outbreak samples data management
- Flexible sample barcoding to facilitate sample coding for all the possible sample types
- Processing of Biosafety sample
- Standard and Lab SOP / Protocol Management
- Sub Sample Management with comprehensive sample and sub samples parent child relationship.
- Test protocol management
- Samples Workflow Management with lab allocation, test allocation, analyst allocation, Resulting, approvals and reporting with actual process tracking at any point of time
- Retesting and repeat testing on residual samples and recalls from sample storage
- Sample Storage Management with vials, racks and containers management inline with requirements of both vertical and horizontal storage
- Dual layer reporting mechanism supporting custom reporting.
- Clinical population studies data analysis system based on the archival of the population data with charting and MIS features
- Complete Electronic Storage of data & reporting
- Data Filtration on user defined parameters
- Seamless integration with spreadsheet(excel) formats
- Comprehensive customizable data analysis ranging from a single sample or patient or to complete array of the database
- Generation of various type of Graphs and Charts



e - S B I M S

Clinical Samples Banking Information Management System

- Laboratory sample security and storage management system
- Efficiently organizes biological and non-biological specimens
- Supports various sample types like tissue, blood, and cells
- Provides secure access control for enhanced security
- Enables sample tracking, storage, retrieval, and reporting
- Offers features like sample registration and Aliquoting
- Supports barcoding/RFID coding for easy identification
- Facilitates sample listing and automatic/manual grid vial allocation
- Allows storage chamber allocation and access grant
- Supports sample movement and handling protocol
- Manages sample release and discard management
- Facilitates sample processing and comprehensive reporting
- Supports single or multiple storage locations for bio-banks
- Allows definition of multiple storage locations with details on the environment, capacity, and graphical view of slots
- Each sample is allocated a specific storage location
- Enables environment audit to assess sample viability in each storage location
- Equipped with long-range RFID scanners for enhanced security
- Alerts and alarms unauthorized movement of samples from restricted equipment or areas
- Enables controlled management of hazardous samples in accordance with Biosecurity protocols

e - S B I M S

Clinical Samples Banking
Information Management System

SYSEBIOME



CLEMS

Critical Lab Equipments Monitoring System



The laboratory Samples and Material Management system relies upon array of temperature and humidity controlled equipments. Any malfunction in the equipment may result in biohazardous situation and also loss of valuable laboratory resources. The Critical Lab Equipments Monitoring System (CLEMS) is designed as a continuous Monitoring and remote alarm system to facilitate such Laboratories

- CEMS is a standalone GSM-based telemetry unit that continuously monitors various parameters of lab equipment.
- The system provides real-time monitoring and remote management of lab equipment in a laboratory environment.
- The system measures basic equipment parameters such as temperature, relative humidity, and pressure of deep freezers, incubators, hot air ovens, etc
- It sends email notifications containing recorded data files and alarm emails to five specified mail accounts.
- Time interval logs are created and stored on the cloud for future reference.
- In case of an alarm condition, the system sends alarm SMS notifications to five designated GSM phone numbers.
- The system can also send current reading SMS notifications on demand to the specified GSM phone numbers.
- During an alarm condition, an external device, such as a hooter, can be activated.
- A common display is available to check the current readings of all the equipment at a single point in the facility.



Digital Therapeutics Platform

Digi-Hospice

Digital Therapeutic Platform
for Palliative Care Ecosystem



Under the Digital Therapeutics initiative, Sysbiome Technologies has designed a comprehensive End to End Digital Therapeutics Platform Infrastructure for delivery of state of the art care system for Terminally Ill Patients in any territory with maximum reach to the patient ecosystem under the name of “Digi Hospice”.

- Our System aims to build and deliver the digital network of all the stakeholders in palliative care segment like Doctors, Patients, Volunteers, Corporations and Society under one umbrella.
- The Platform delivers support services including development of Palliative care wards, comprehensive training of general dispensaries and hospitals.
- Development and efficient supply chain management of palliative care kit and other requisites to deliver the efficient palliative care to terminally ill population with maximum coverage,
- To provide best-in class health and pain management facilities to its terminally ill patients through the below mentioned approach.
 - Integration of all available and upcoming Hospice centers across the Geography
 - OPD process management, IPD process management, Home care patients management through local level healthcare facilities (PHC's)
 - Controlled drugs delivery monitoring
 - Automated patient ESAS based assessment followed by integrated point of care device data processed through artificial Intelligence to facilitate Palliative care Doctors to deliver best of medical services to patients remotely

DigiHospice is built with support of latest software technologies and Artificial Intelligence system to act as palliative care in itself on web and mobile platforms to support remote reach for patient care. The system optionally is comprehended with well equipped call centre and connected online doctor panel from field of Oncology, Radiology, Psychiatry Psychology and pain management.



BLOODBANKS PLUS

Electronic Integrated Blood Banks Management System



- All-in-one solution for managing Integrated blood banks
- Public interface software system with built-in Haemovigilance system
- Relationship Management features, including:
 - Inter Blood Banks
 - Blood Banks and Hospitals
 - Blood Banks and Industry/Research Organisations
 - Blood Banks and Audit Agencies
 - Blood Banks and Voluntary Donors
 - Blood Banks and Governing Bodies
 - Blood Banks and donor database
- Public interface portal and tele-centre for displaying stock position of blood and blood products across all blood banks
- Walk-in requesters can check availability status of blood from any blood bank if not available in a particular blood bank
- Checks illegal/professional donation through a biometric database of donors for the geography
- Limits donors to maintain donation gap, temporary deferment, and permanent deferment
- Comprehensive national voluntary and actual donor data basing
- Online/telephonic/SMS-based blood and components searching
- Donor registration and blood booking
- Optional bulk blood delivery system
- Comprehensive management of special recipients like thalassemia with no dependency on a single blood bank
- Integrated with Haemovigilance system, including:
 - Donor Deferment Statistics Report
 - In Donation Process ADR Reporting
 - Post Donation ADR Reporting
 - ATR Reporting during transfusion
 - ATR Reporting after transfusion
- Auditable Blood Banks Process Management



Healthcare Informatics

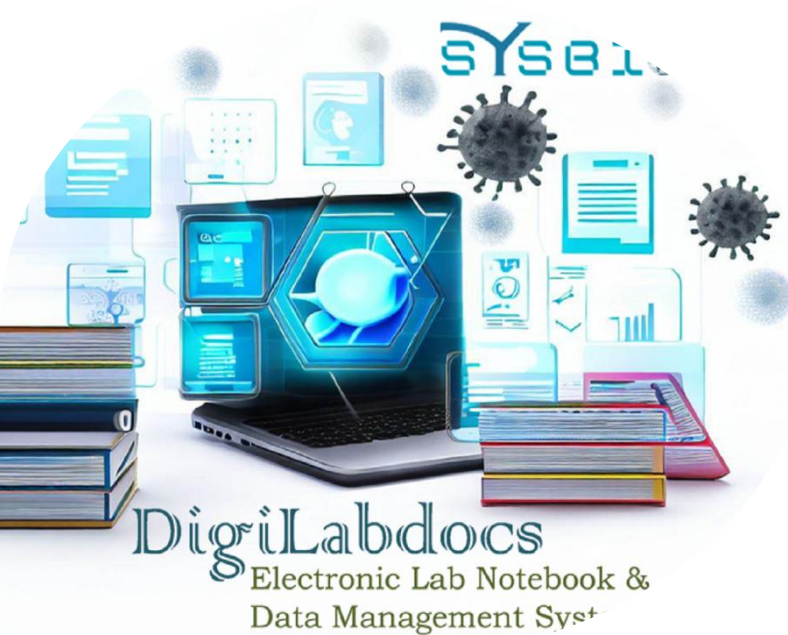

- Revolutionize your lab operations with DigiLabdocs - the ultimate solution for electronic lab notebook, data, users & documents.
- Say goodbye to tedious paperwork and hello to a streamlined digital workflow.
- Effortlessly create, store, and manage all your lab documents in one secure platform, accessible anytime, anywhere.
- With DigiLabdocs, experience increased efficiency, accuracy, and compliance while saving valuable time and resources.

- Take the hassle out of managing healthcare cohort studies with our state-of-the-art software system.
- Designed to simplify every step of your research journey, from data collection to analysis and reporting, our platform is here to supercharge your studies.
- Whether you're conducting field research or lab experiments, our comprehensive solution ensures accurate and efficient data management and analytics.



- Say goodbye to tedious manual processes and welcome a seamless experience that streamlines your work.
- Join the ranks of successful researchers who trust our software to effortlessly manage their cohort studies.

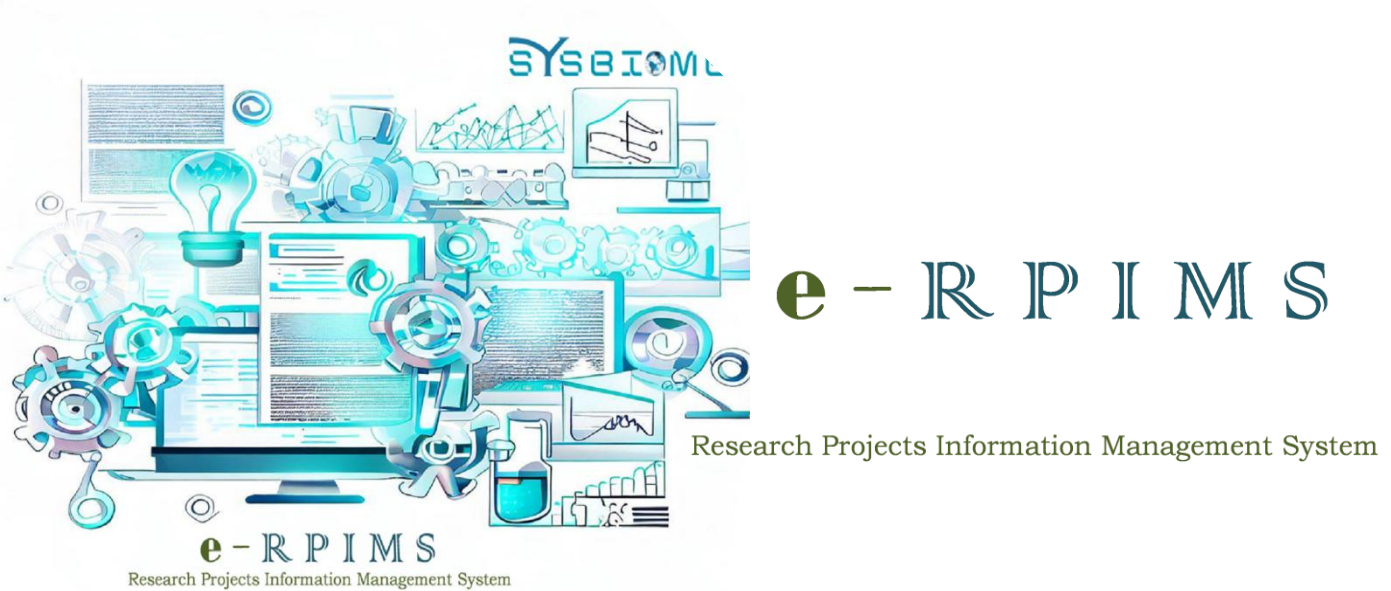

Electronic Research Projects Information Management System (eRPIMS) is comprehensive software tool to manage all the Research projects in any Healthcare or Core Research and Development Institutes.

The System manages all the aspects of in-house projects or collaborative projects starting from Peer Review meeting to Project planning, Accounting, procurements, HR, Publications, Training, Charting and Reporting

- Projects Projection In Five Year Plans
- Peer Review Meetings Management
- Project Registration
 - Project Frame
 - Project Sanction Management
 - Equipment Procurement Management
- Project Process Management
 - Project Manpower Management
 - Project Accounts Management
 - Project Meetings Management
 - Project Associate Management
 - Sub Projects/ CARS/ Task Management
 - Project Status Analytics Through PERT-CPM
 - Project Technical Reports Management
 - Project based Publications, Patents, Copyright and other IPR management
 - Project Members, Deputations, Fields and Training Resources Management
 - Project Closure Management
- Reports & Analytics



Say goodbye to manual processes and embrace a seamless, audit-ready environment. Blood Bank Pro streamlines critical operations, ensuring that every step - from inventory management to donor coordination - is flawlessly executed. Plus, with its fully customizable features, the solution adapts to your specific needs, providing a tailored experience that meets the unique requirements of your blood bank.

Portal Module

- Voluntary donor registration with declaration
- Voluntary donor search
- Camp Information display with camp donor registration
- Camp organisation request form
- Blood and Blood Product search
- Blood requisition
- Special patients registration
- Hospitals & other organization registration
- Donor Login
 - Test Reports
 - Lost donor card reporting
 - Deferred donor details
 - Acknowledgements
 - Change profile, address, mobile etc
 - Blood requisition
 - Blood Donation history
- Camp Volunteer registration
- Donor forum and blogs
- Blood Status position Posting
- Excess stock posting
- Access control of donor through biometric interfaces
- automatic Stock position updation at defined intervals
- Posting deferred donor report and acknowledgements to successful donors



Software Application Module

Donor registration

- Individual
- Mass registration
- Screening Details
- Donor Card Printing

Donation Type

- Apheresis
- Whole blood
- Component Preparation

Testing Requisition printing

Samples—Labs—results—
Approval—Reporting— Storage
information - Labels for bags

Storage Management

Reserve and regular stock
management
Issue Management(FIFO)—Cross
Matching - Issue label printing—
Individual issue—Bulk Issue—Return
management

Stock Expiry alerts and posting to
portal

Stock position to portal

Posting deferred donor report
automatically and acknowledgements
to successful donors

Blood Bags management

Comprehensive bar coded/QR
coded/RFID label printing



Enterprise Informatics- SaaS

e-Trainings Resources Management Software manages the training programmes for in-house trainings both to external pupil as well as internal candidates.

Record selected candidates for training - Issue the invitation letter - Candidate Reporting - Instructor Management - Topic Management - Training Literature Management - Training Extension Management - Trainee Resignation Management - Trainees Project Report Archiving - Training Completion Certificates - Trainee Details Archiving.

Process flow for the training management of the

Annual Training Budget Master - Training Programmes(Internal or External)Display in dashboard - Training Request Generation by the Employee(Listed or Unlisted) - Approvals (Based on the approval logics followed by the organization) - Candidate Nomination - Training Charges and Payments - Training Amendments - Training Completion Reporting - Literature Archiving - Institutional decision support in selection of employees for roles based on the training skill set.



The software e-PRMS (Electronic Physical Records Management System) is the in-house development to comprehensively manage the record keeping and movement tracking of all physical documents, letters, emails, faxes, notices & circulars of any organization.

e-PRMS- Diary & Dispatch Management

e-PRMS- Files Management & Tracking System

e-PRMS- Enterprise Edition (Combining e-PRMS-FMS & e-PRMS-D&DMS)

e-PRMS is the electronic repository and management system of all the activities related to creation, management, organization, custody, tracking and life cycle management of the Physical Records in any organization.

The software system operates hand in hand with the conventional methods followed in any organizational workflow and thus facilitates smooth transition from conventional to technological approach.



Healthcare Biosafety Infrastructure

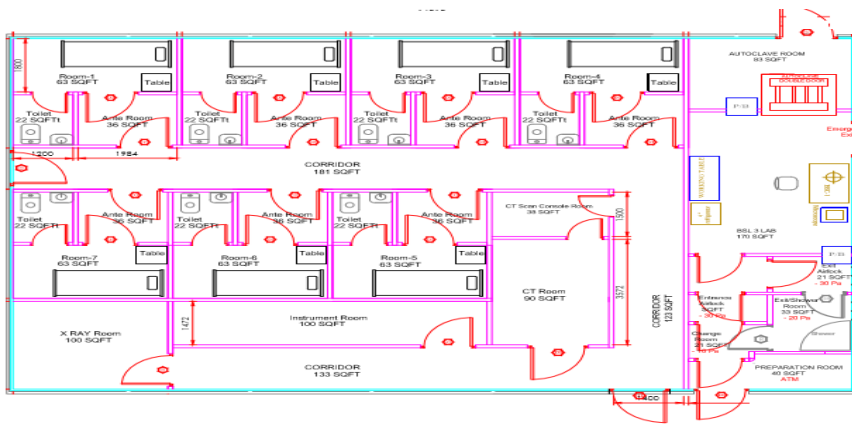
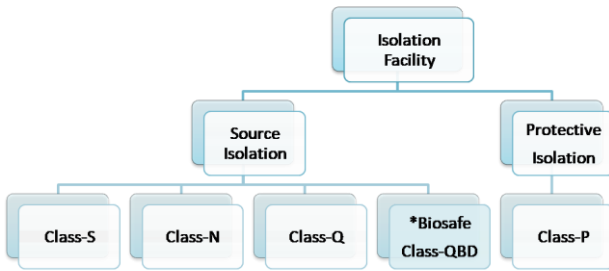

CLASS-QBD

Quarantine Class having Cascading Negative pressure and anteroom. The Facility has an integrated BSL3 Diagnostic facility to facilitate onsite and infection controlled diagnostics

CLASS-Q

Quarantine Class with cascading Negative air pressure and additional barriers including an anteroom

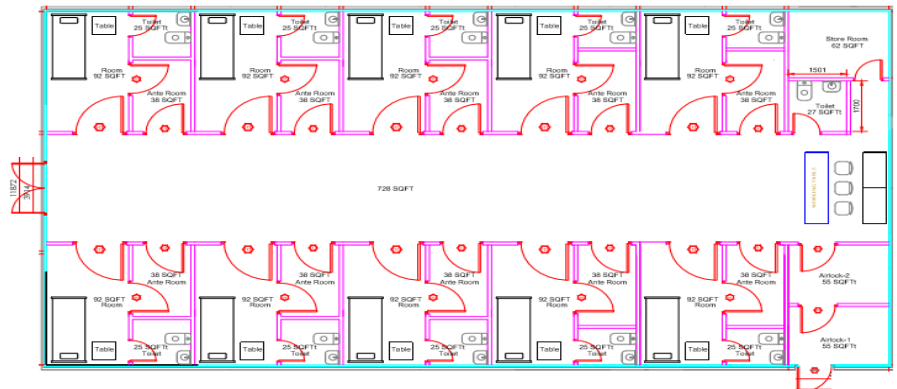

Features

- Built to protect healthcare workers handling the patient, visitors and environment from transmission of infectious agents.
- Turnkey establishment or up gradation of Isolation ward integrated in the hospital building facility or in array of customized container
- Custom design Class Q- with Integrated BSL3 RT-PCR Diagnostic facility, Class Q- Quarantine isolation with negative pressure and Ante Room, Class N- Negative Pressure Room or Ward, Class S- Standard Pressure with Integrated Air purification system or mix of the various class of Isolations.
- Any of the offered Isolation facility comes with integrated sterilization system for Air, Liquid and Solid medium of infectious agents.
- Automated control systems allow optimization of resource

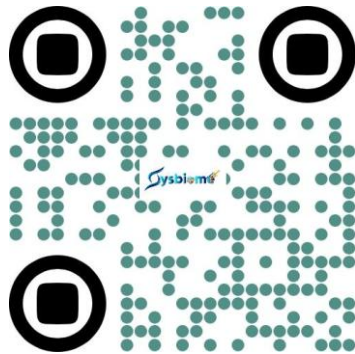

+ 91 120 66 181 66

info@sysbiome.com

 /company/sysbiome-technologies

 /sysbiome

 /sysbiomeofficial

 /sysbiome

 9999 759 749

SYSBIOME